

Редуктор, Мотор-редуктор RCV 381 VARMEC

CV RCV	i	$n_1 = 2800 \text{ min}^{-1}$			$n_1 = 1400 \text{ min}^{-1}$			$n_1 = 900 \text{ min}^{-1}$					
		n_2 min ⁻¹	Mn_2 Nm	P_1 kW	n_2 min ⁻¹	Mn_2 Nm	P_1 kW	n_2 min ⁻¹	Mn_2 Nm	P_1 kW	IEC B5	IEC B14	NEMA
381	1.63	1718	77	14.1	859	92	8.4	552	92	5.4	80-90-100/112-132	132	140-180-210
	2.29	1223	79	10.3	611	94	6.1	393	95	4.0	80-90-100/112-132	132	140-180-210
	3.00	933	92	9.2	467	110	5.5	300	110	3.5	80-90-100/112-132	132	140-180-210
	3.38	828	92	8.1	414	110	4.9	266	111	3.2	80-90-100/112-132	132	140-180-210
	4.11	681	96	7.0	341	115	4.2	219	115	2.7	80-90-100/112-132	132	140-180-210
	4.75	589	106	6.7	295	126	4.0	189	127	2.6	80-90-100/112-132	132	140-180-210
	5.57	503	108	5.8	251	130	3.5	162	130	2.2	80-90-100/112-132	132	140-180-210
	7.36	380	110	4.5	190	132	2.7	122	133	1.7	80-90-100/112-132	132	140-180-210
	10.40	269	116	3.3	135	138	2.0	87	139	1.3	80-90-100/112	132	140-180-210

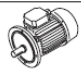
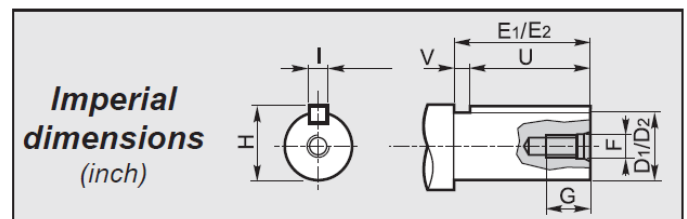
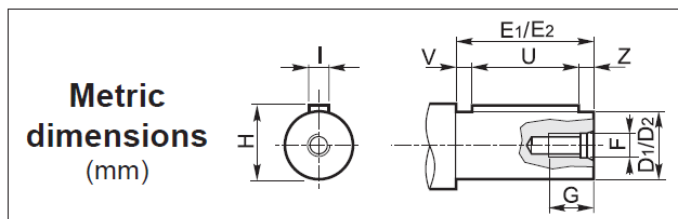

① **Albero entrata / Input shaft / Antriebswelle**
Arbre d'entrée / Eje de entrada / Eixo de entrada

D_1 h6	E_1	F	G	H	I	U	V	Z
28	60	M10	20	31	8	50	5	5

① **Albero entrata / Input shaft / Antriebswelle**
Arbre d'entrée / Eje de entrada / Eixo de entrada

D_1	E_1	F	G	H	I	U	V
1.125	2.362	5/16-18	0.709	1.236	0.250	1.750	0.612

② **Albero uscita / Output shaft / Abtriebswelle**
Arbre de sortie / Eje de salida / Eixo de saída

D_2 h6	E_2	F	G	H	I	U	V	Z
28	60	M8	18	31	8	50	5	5
30	60	M10	22	33	8	50	5	5
32	80	M10	22	35	10	70	5	5
38	80	M12	28	41	10	70	5	5
40	80	M12	28	43	12	70	5	5

② **Albero uscita / Output shaft / Abtriebswelle**
Arbre de sortie / Eje de salida / Eixo de saída

D_2	E_2	F	G	H	I	U	V
1.625	3.150	1/2-13	1.299	1.792	0.375	2.500	0.650

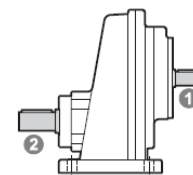

Редуктор, Мотор-редуктор RCV 381 VARMEC

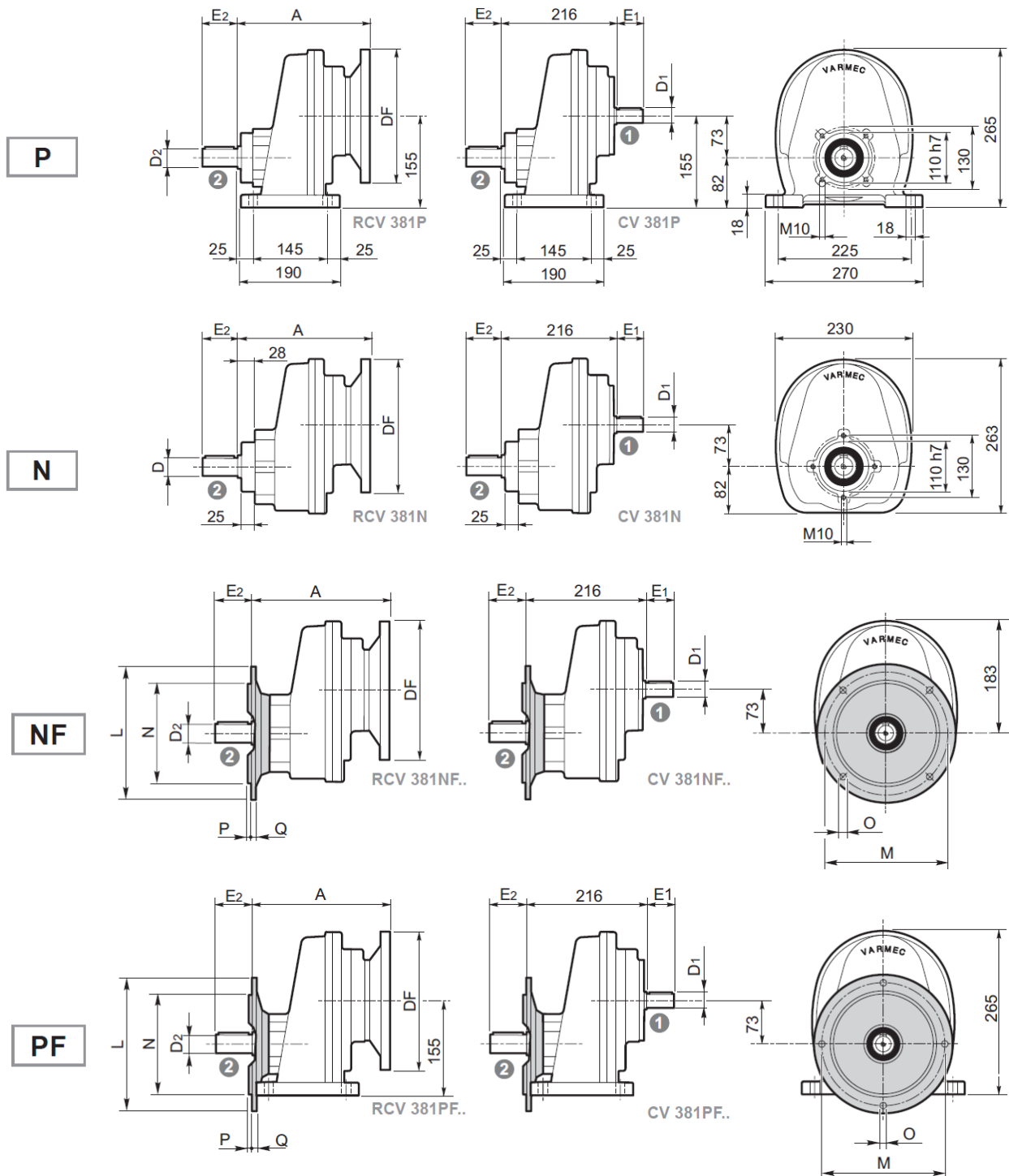

RCV CV	RCV						
	IEC	DF		A	NEMA	DF	A
		(B5)	(B14)				
381	80	200		221	140	165.1	237
	90	200			180	228.6	243
	100	250			210	228.6	243
	112	250					
	132	300	200	236			

	L	M	N h8	O	P	Q
NF200 - PF200	200	165	130	14	4	14
NF250	250	215	180	14	4	14
NF300	300	265	230	14	4	14